

Statement

I am _____, Superintendent of the Upper Fork Mine. Thank you for responding to our call. This mine is just a few weeks old but we have encountered several bad conditions. Last night a five man crew entered the mine to do some clean up work and maintenance. An electrician came outside to get some parts but while traveling back to the section there was a strong smell of smoke. He tried several times to reach the other miners but was unsuccessful. He then traveled back up the slope where he reported what he found to the outside man.

This mine is ventilated by an exhaust fan shaft and an intake shaft. The fan is now off but can be turned on at the switch on the surface. Once started, the fan must remain in exhaust mode and can not be turned off or stalled. All other electrical power to the mine is de-energized. The maps we have are up to date and other rescue teams are not here to provide back up.

Problem

- Locate all missing miners.
- Bring survivors to the surface.
- Explore all areas of the mine which can be done so safely.

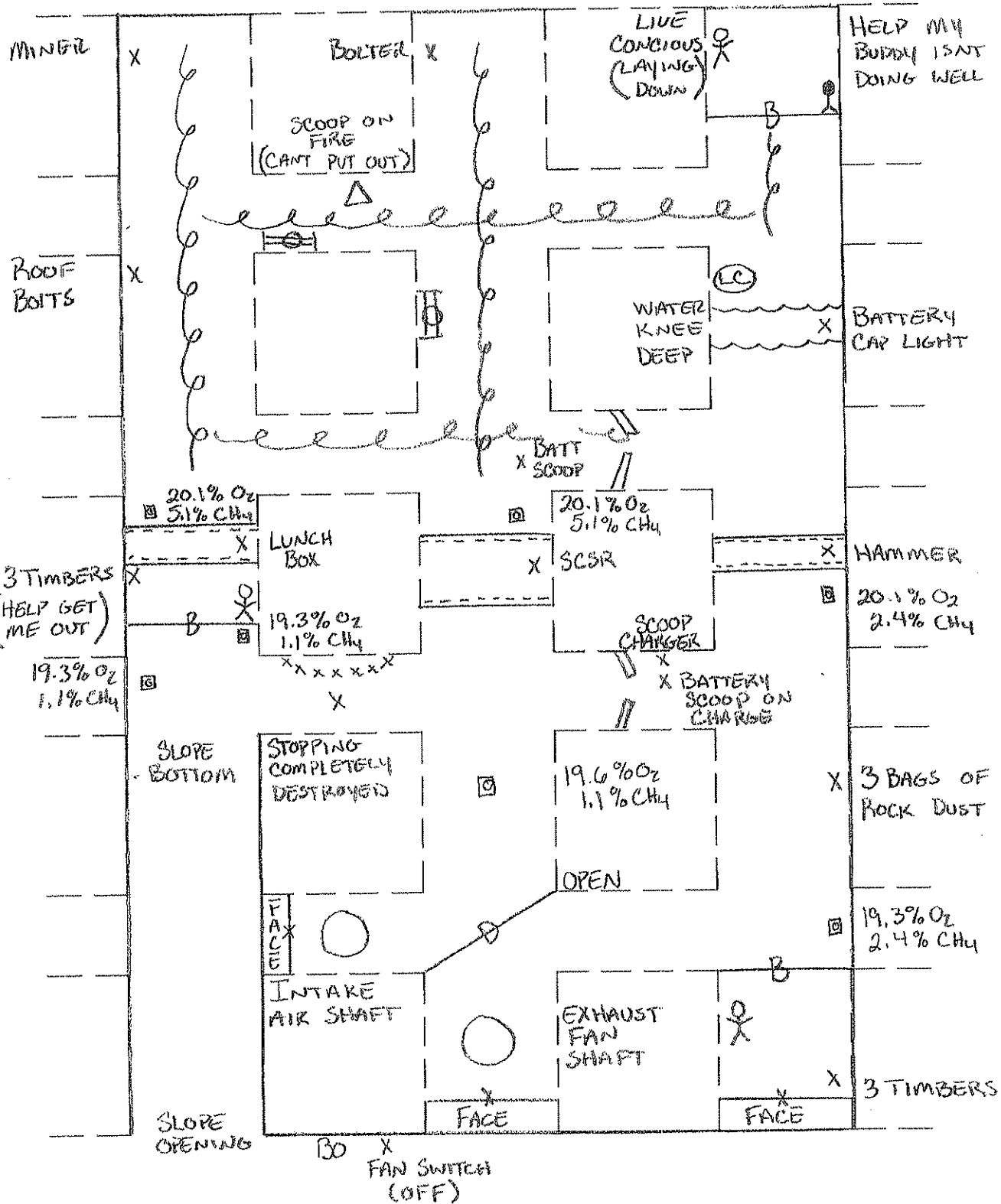

VENT #1

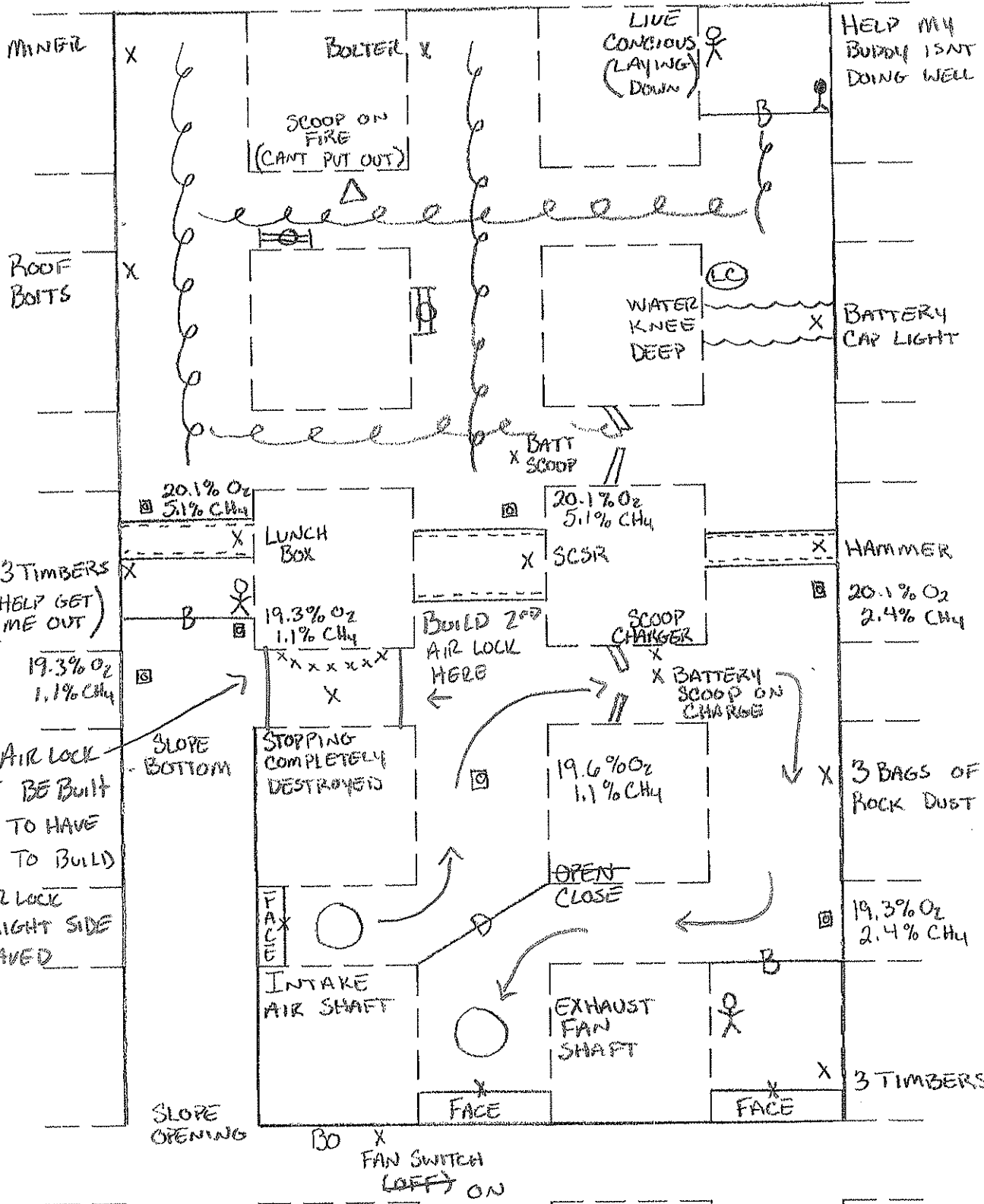

1ST AIR LOCK MUST BE BUILT HERE TO HAVE ROOM TO BUILD 2ND AIR LOCK ON RIGHT SIDE OF CAVED

SLOPE OPENING
BO X FAN SWITCH (OFF) ON

VENT #2

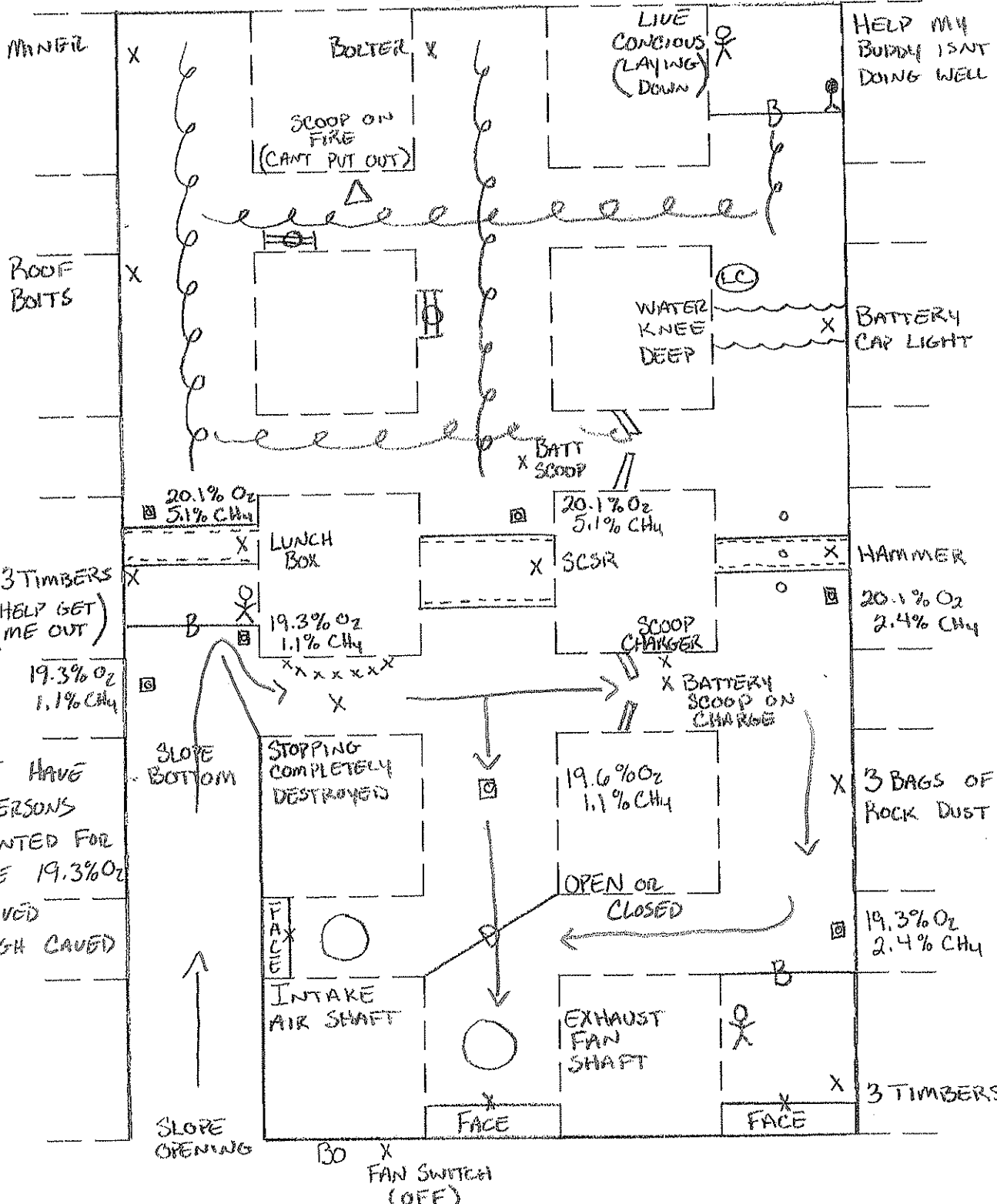

MUST HAVE ALL PERSONS ACCOUNTED FOR BEFORE 19.3% O2 IS MOVED THROUGH CAVE

SLOPE OPENING

BO X FAN SWITCH (OFF)

3 TIMBERS

VENT #3

