

**INDIANA  
MINE RESCUE CONTEST  
2009**

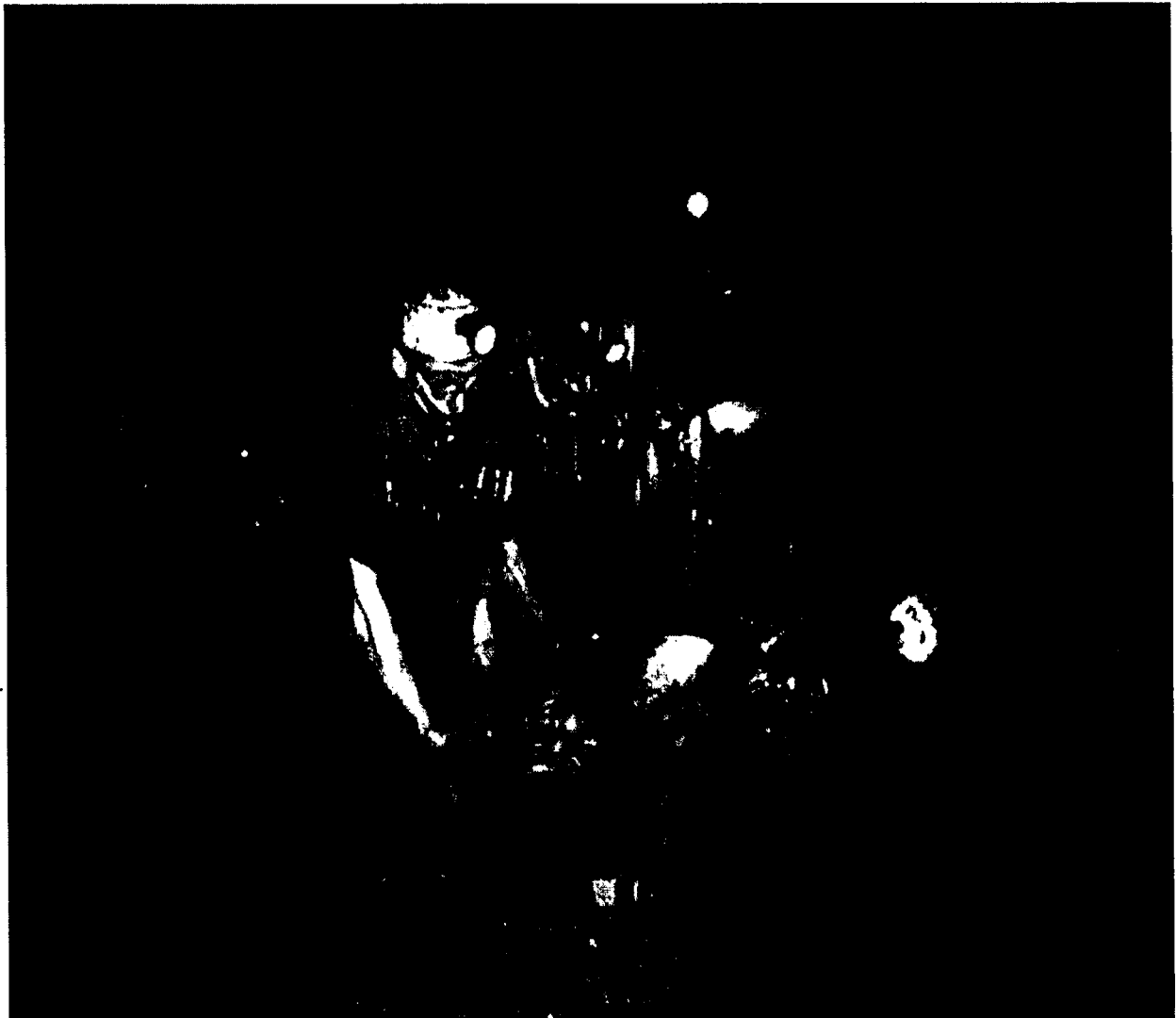

# INDIANA

## Mine Rescue Contest - 2009

### Statement

I am \_\_\_\_\_, Superintendent of the Lucky 13 Mine. You are located at the fresh air base on the Main North Section. This fresh air base was established when conditions were encountered that no longer permitted bare face exploration.

The Main North Section is developing 3 entries off the Main West Sub Main panel and is preparing for a new shaft to be holed into the mine. A 10 foot diameter shaft is being blind bore drilled into the mine. The coal seam is at or near the 550 foot depth. This shaft remains full of water during the drilling operations and was down to 525 feet in depth. At 12:01 AM this morning an 8 man crew entered the Main North Section of the mine to finish preparation work for holing of the mine shaft. At 4:00 a.m. the shaft sinking crew heard a loud noise and felt a rush of air out of the shaft. The shaft sinking crew observed that the water in the shaft was gone. Several attempts were made to contact the Main North crew to no avail. At 6:00 a.m. a single miner walked out of the mine and was given first-aid.

This section has experienced high concentrations of methane gas, bad roof conditions and water problems in the past. Also, the terrain in the Main North Section has been known to go from flat to rolling hills in a very short distance. The power going into the mine has been de-energized and locked-out, but will be established at a later time. The mine is ventilated by a blowing fan that is in operation and may not be reversed, shut off or stalled out. The top of the new shaft has been examined.

All proper authorities have been notified, a command center has been established on the surface, and back-up mine rescue teams are standing by if needed.

The mine map is up-to-date.

This is all the information we have available at this time.

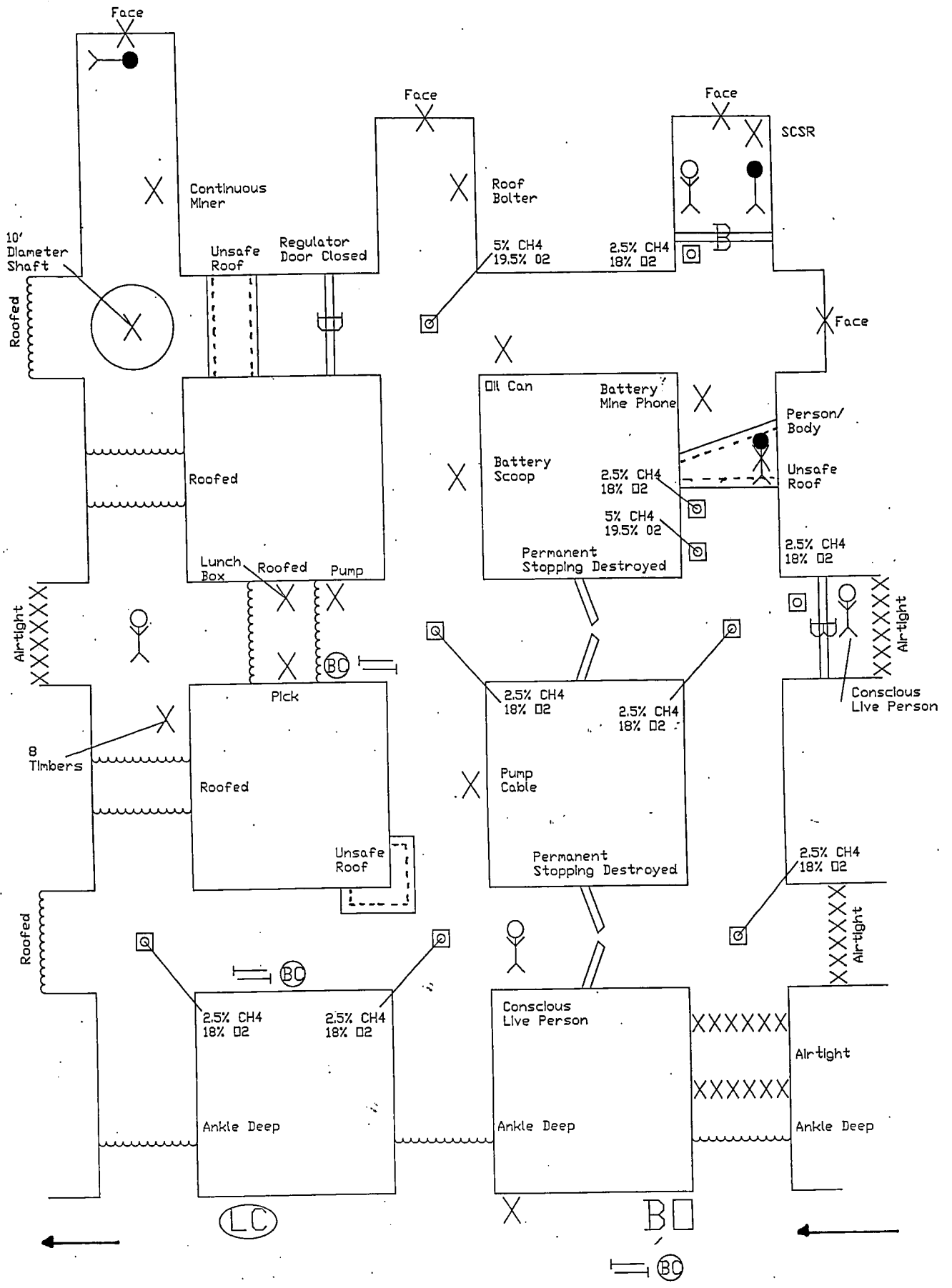

# PROBLEM

Explore all areas of the mine that can be done safe.

Account for all missing persons/bodies.

Bring all survivors to the fresh air base.

Leave the entire mine so that it may be examined barefaced.

# Patient Statement

**Help! Help!**

**Get me out of here.**

**I'm wet and cold.**

# Patient Statement

**Help! Help!**

**Get me out of here.**

**It is airtight behind me.**



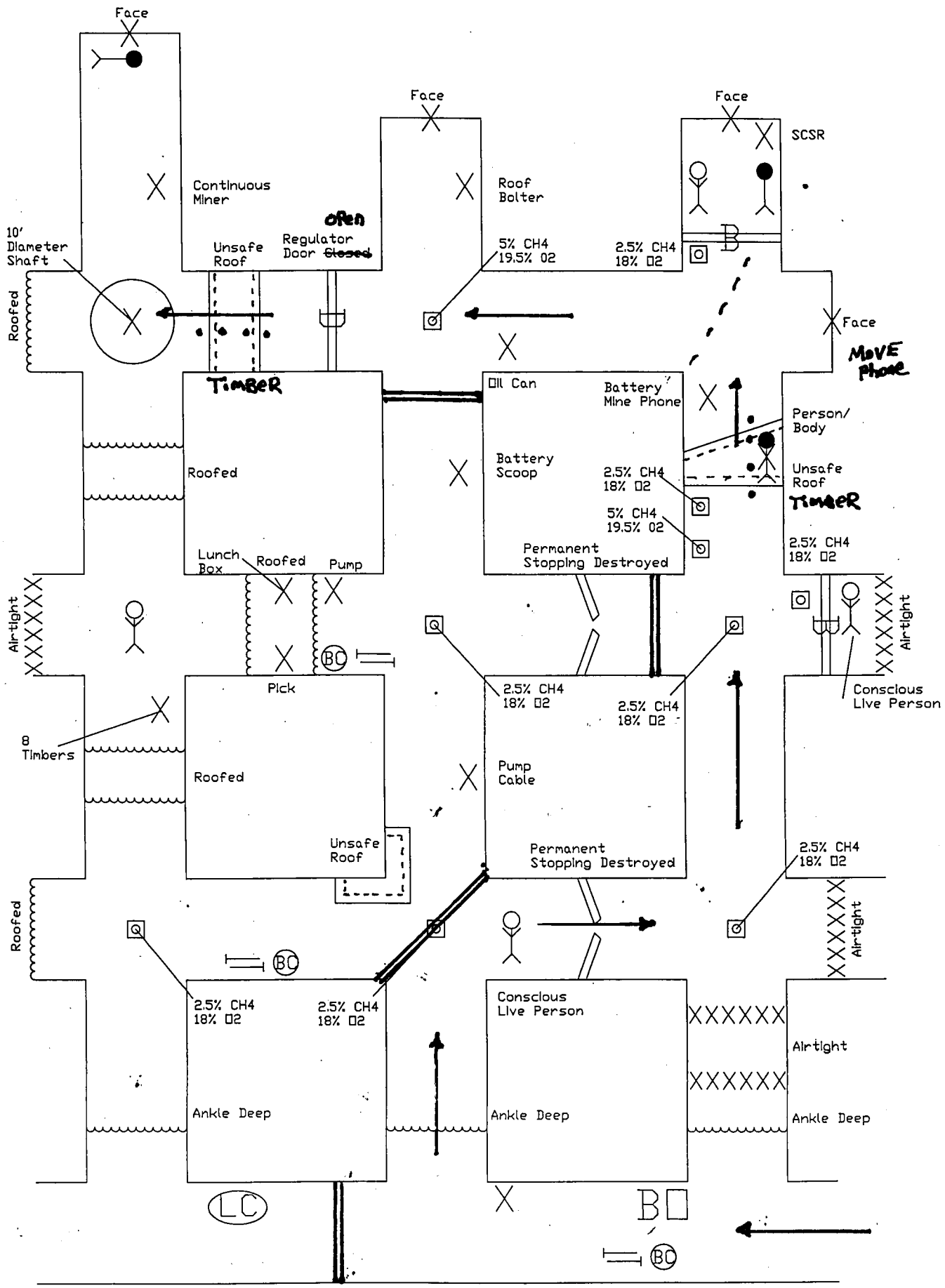

SECOND VENTILATION

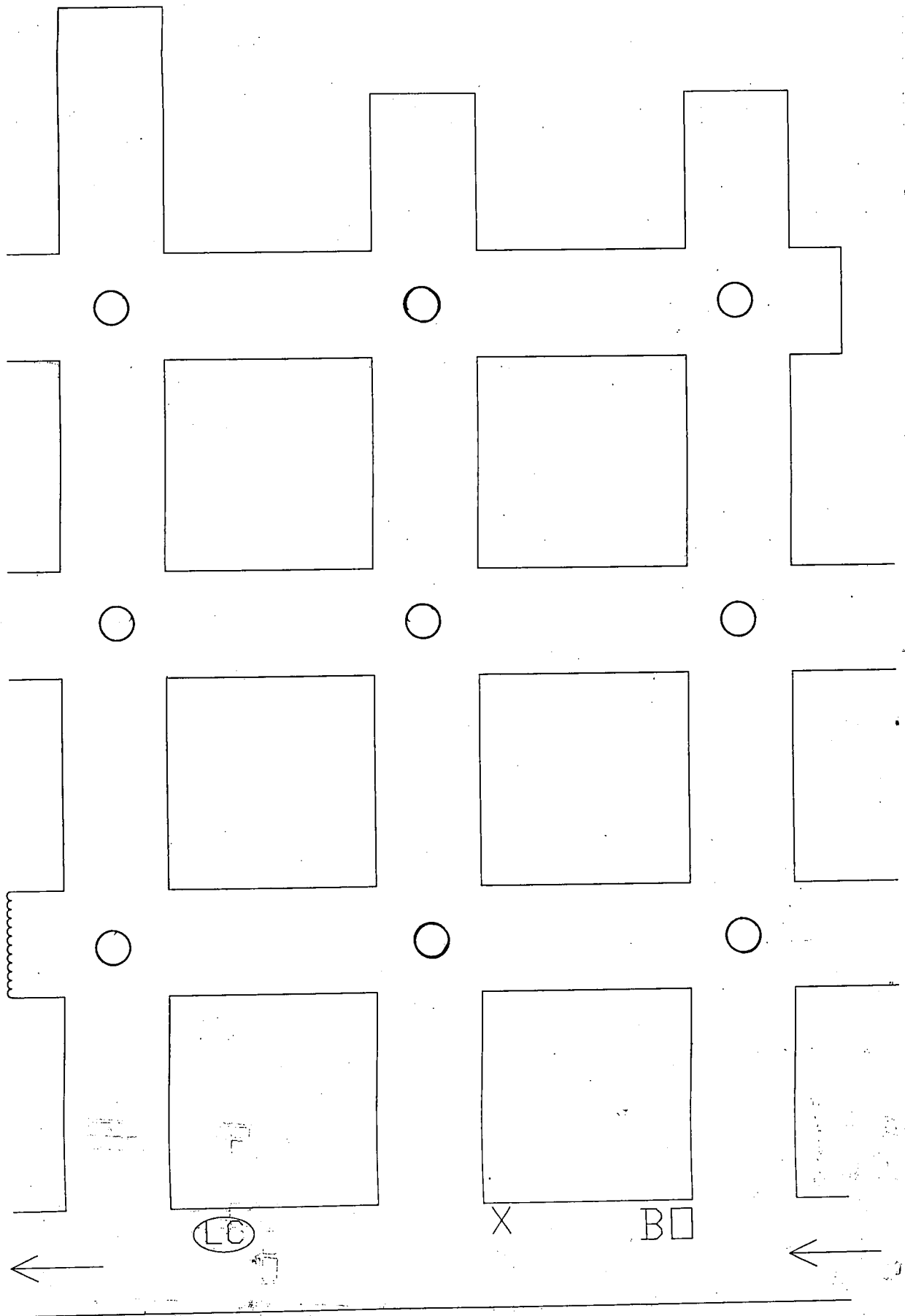

Team Stops

Team No. \_\_\_\_\_  
Field No

# Indiana Mine Rescue Contest 2009

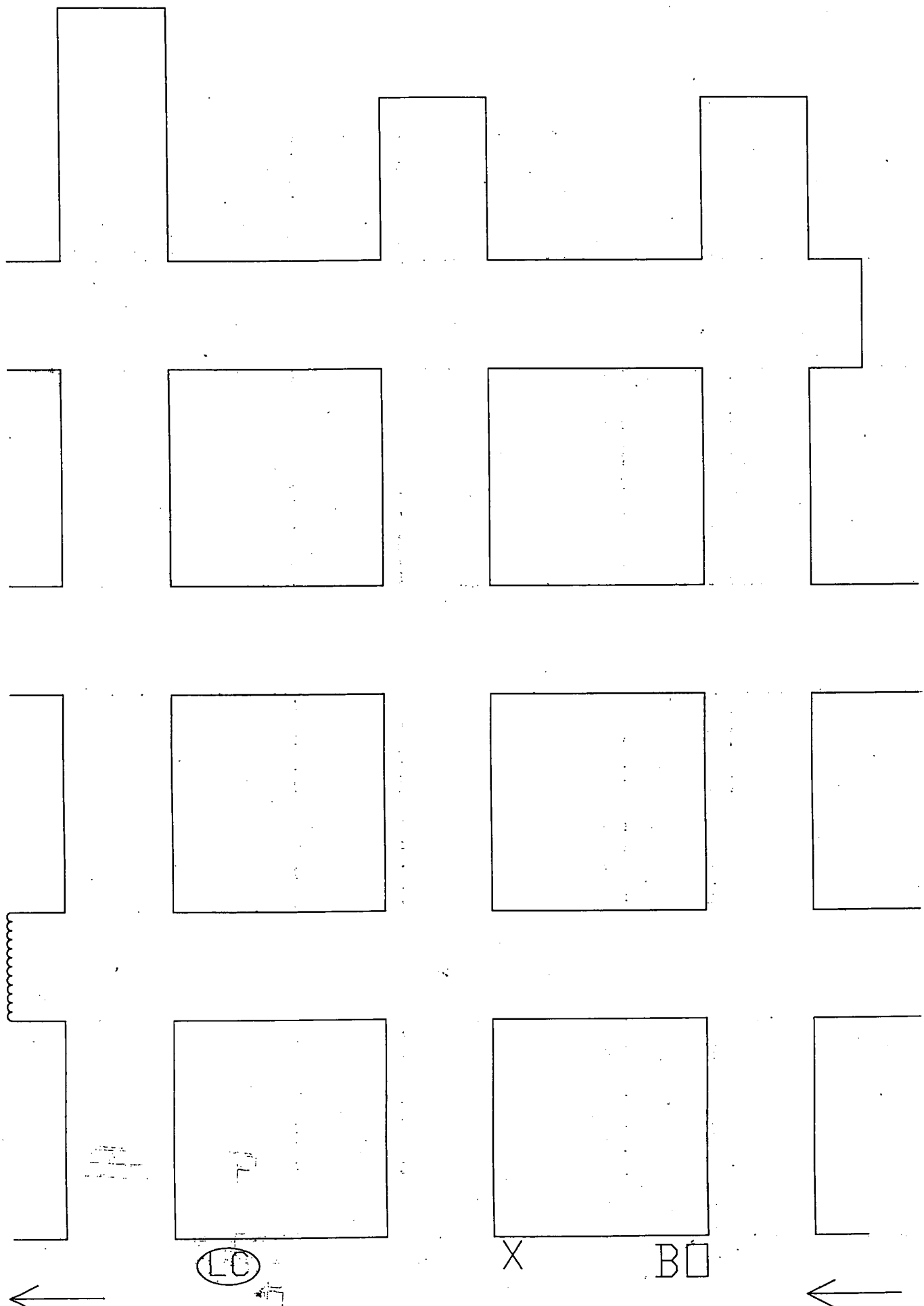

# Indiana Mine Rescue Contest 2009

