

FACE

CUT THROUGH to the surface Impossible

Cut through to the surface impassable

O₂ 14.2%
CH₄ 14.2%
CO 14 PPM

AIRTIGHT

X 6 Timbers

Once team gets to here they can ventilate RA

↑ 9' ↓
SCOOP TIRE

UNCONSCIOUS live person
PERSONS/BODY

OPEN BORE HOLE

O₂ 19.2%
CH₄ 3.2%
CO 8 PPM

Roofed

Roof bolts SHOVEL

O₂ 19.2%
CH₄ 3.2%
CO 8 PPM
Response

Team must tie to # three (607) before across to #1 (849)

Broken Pump Roofed

WATER OVER KNEE DEEP PIPE WRENCH

O₂ 19.2%
CH₄ 3.2%
CO 8 PPM

Battery Mine Phone

Roofed
O₂ 19.6%
CH₄ 6%
CO 6 PPM

Rock Dust Bags

Battery Scoop
WEDGE BOARD

AXE

CRIB

Team can start in any entry

Team Stops

X X X X AIR TIGHT

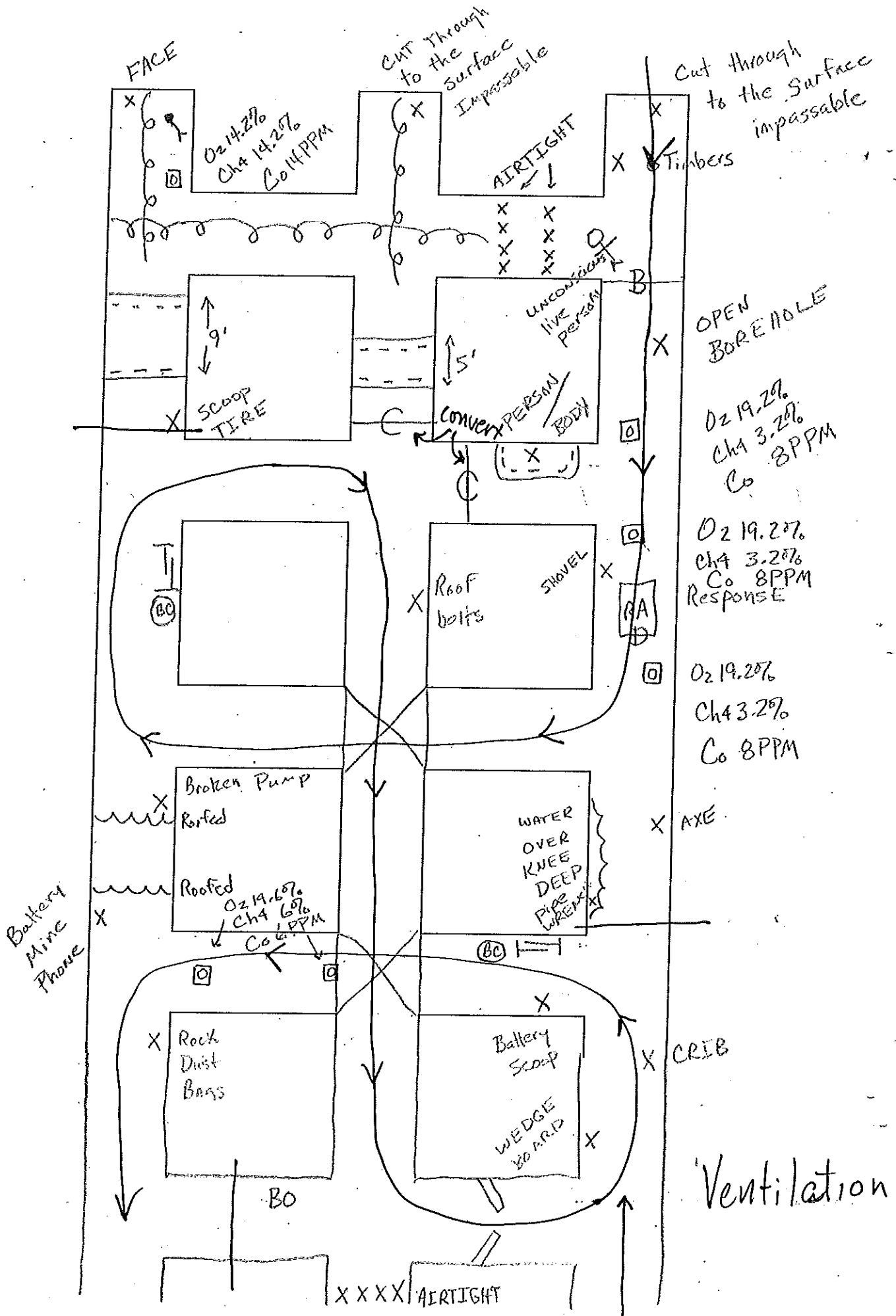

Once team ventilates RA they will timber to unexplored area. Must either turn off fan or airlock. When find explosive mixture they must withdraw.

